



J-TECH DIGITAL[®]

USER MANUAL



USB 3.0 TO DUAL HDMI DISPLAY ADAPTER

JTD-3006 | JTD-USB-2HDMI

J-TECH DIGITAL INC.
9807 EMILY LANE
STAFFORD, TX 77477
TEL: 1-888-610-2818



E-MAIL: SUPPORT@JTECHDIGITAL.COM

Scan the QR code below, or visit <https://resource.jtechdigital.com/products/3006> to view and access detailed digital resources regarding this unit.



Safety Instructions:

Before using this product, please carefully read the following safety instructions to ensure its proper use and keep this manual for future reference:

- To prevent electric shock, do not attempt to open the product.
- Only qualified personnel should perform any repairs or maintenance.
- Always place the product on a stable, flat surface to prevent it from falling.
- Do not expose the product to water, moisture, or high-humidity environments to avoid the risk of damage.
- To prevent damage from direct sunlight or high temperatures, do not expose the product to such environments.
- Do not place the product near heat sources like radiators, heat registers, stove, or other heat-producing apparatus.
- Do not place any objects on top of the product to avoid damage.
- Use only the attachments and accessories specified by the manufacturer.
- During lightning storms or prolonged periods of disuse, unplug the power supply to prevent damage.

Table of Contents

- 1. Introduction5
- 2. Package Contents.....5
- 3. Panel Description.....5
- 4. System Requirements.....6
- 5. Features.....6
- 6. Resolutions7
- 7. Display Mode Settings7
- 8. Supported Resolutions..... 10
- 9. Specifications..... 11
- 10. Connection Diagram 12
- 11. Troubleshooting Common Issues 13
- 12. Maintenance 14
- 13. Warranty 14
- 14. Mail-In Service 14
- 15. Limited Warranty Limits and Exclusions 14

1. Introduction

The USB 3.0 to HDMI Dual Display Adapter, which connects USB-A or USB-C to two HDMI displays. This adapter is designed to support Mirror/Extend/Rotation/Clamshell modes and can display up to 4K@30Hz and 1080p@60Hz. We have tested this product to meet all specifications and features. To ensure long-term enjoyment of this product, please read the following information before installation.

2. Package Contents

- USB 3.0 to HDMI Dual Display Adapter
- User Manual

3. Panel Description

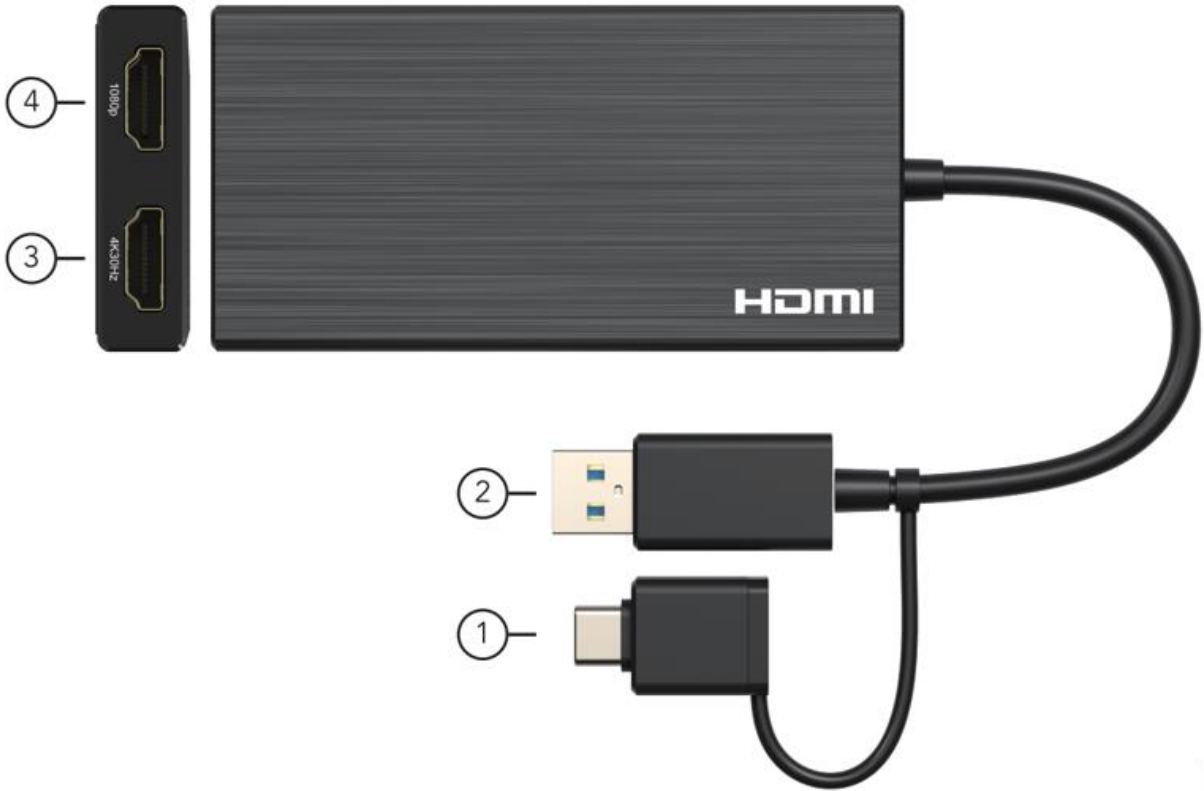

1. USB-C Male Adapter: Connect to the USB-C Enable Laptop/Notebook with USB3.0 Data Output
2. USB3.0 Port: Connect to the USB 3.0 Data Port of the PC/ Laptop/Notebook/USB 3.0 Hub
3. 4K30Hz: Connect the Original Port to Output Resolution up to 4K@30Hz Max
4. 1080p: Connect the Port to Output Resolution up to 1080p Max

4. System Requirements

To ensure proper installation and operation of this product, please ensure that your system meets the following requirements:

- Windows 7/8/8.1/10 and above or Mac OS 10.10.x and above.
- CPU Processor: Core i5 and above.
- RAM: 4GB and above.
- Monitor: Supports 4K resolution.

5. Features

- Dual display output, supporting one display at 4K@30Hz and another at 1080p@60Hz.
- Supports video decoding in multiple formats, including H.264, H.263, MP4, MP2, DivX, AVS, JPEG, and more.
- Compatible with USB-C, USB-A, Thunderbolt 3/4, and USB 4 standard ports.
- Allows you to extend your PC screen to multiple displays, supporting up to 8 displays on Windows and up to 6 displays on Mac OS.

6. Resolutions

OS/Ports		2K Port	4K Port	4K Port
Windows	Mirror mode	1920x1080@60Hz	1920x1080@60Hz	Or 3840x2160@30Hz
	Extend mode	1920x1080@60Hz	3840x2160@30Hz	
Mac OS	Mirror mode	1920x1080@60Hz	3840x2160@30Hz	
	Extend mode	1920x1080@60Hz	3840x2160@30Hz	

Driver Installation

Enter the website: <https://resource.jtechdigital.com/products/3006> and download the correct driver zip file.

7. Display Mode Settings

For Windows:

1. Right click the blank space on the desktop and select “Display settings”

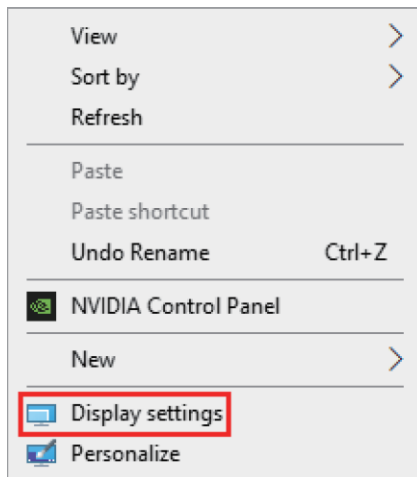

2. At the “Display” area, click each of the display icons to set the needed resolution or other setting

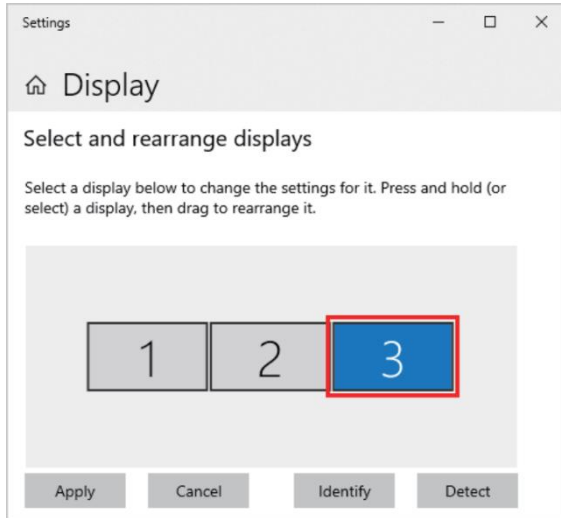

3. Scroll down to “multi display settings” and select the desired mode in the drop-down list

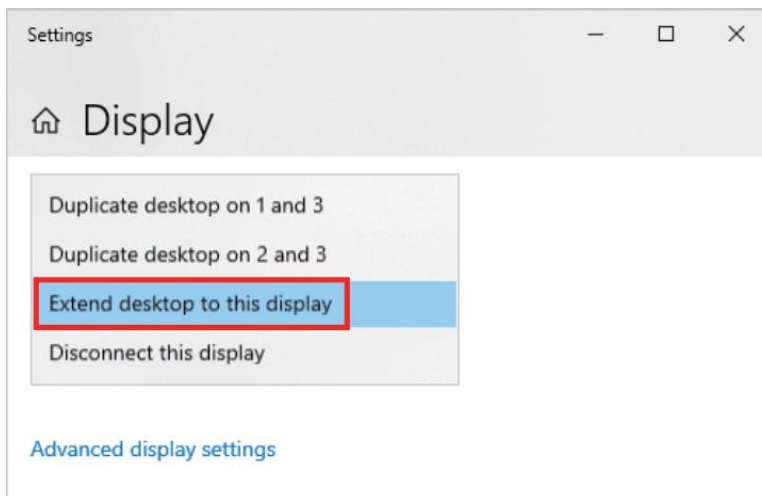

For Mac OS:

1. Left click the apple icon and select “System Preferences”, and click the “Displays”

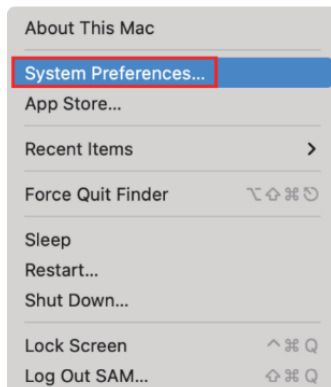

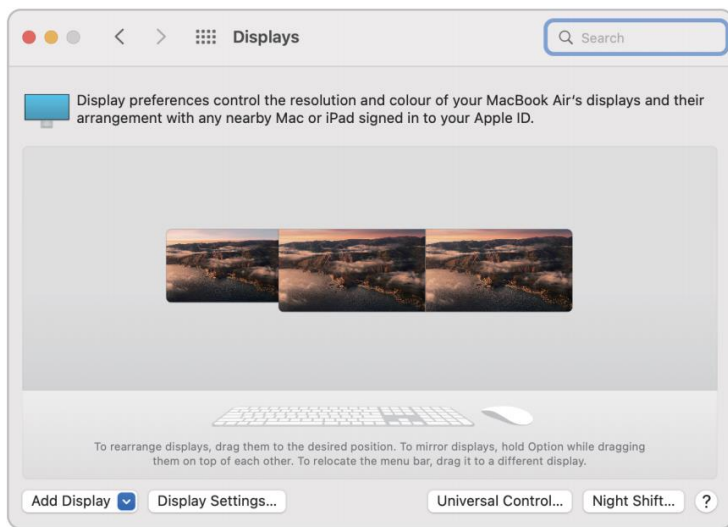

3. Click the “Display Setting”, and choose each connected display to set correct resolution and mode

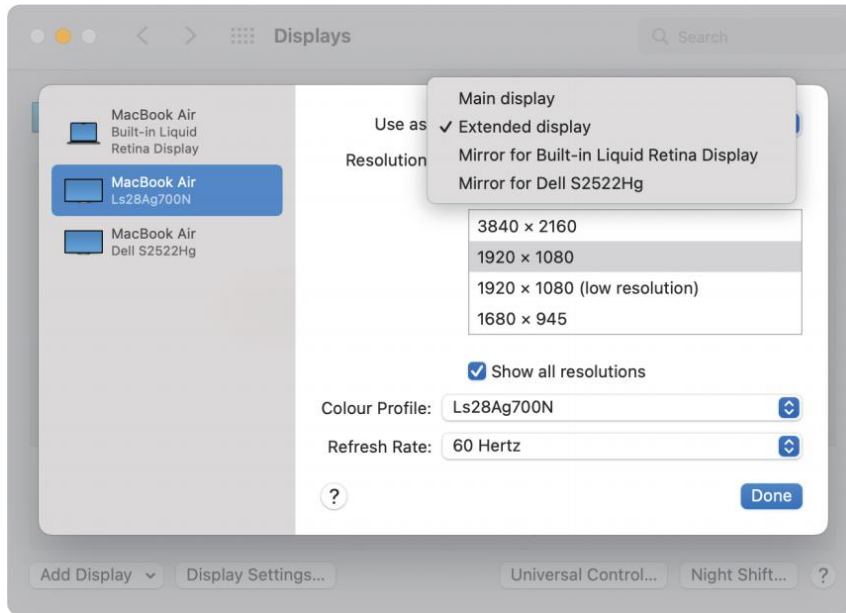

Note

- Please note that Mac-based devices do not support rotation mode, but M1/M2 Mac supports clamshell mode while Intel Mac does not.
- To use this adapter, your USB-C™/USB3.0 equipped device must support USB 3.0 data transmission.
- Please be aware that this adapter does not support playback of HDCP-protected content on sites like Netflix and Hulu.

8. Supported Resolutions

	1080p Port	4K30Hz Port
Windows	1920x1080@60Hz	3840x2160@30Hz
	1680x1050@60Hz	2560x1440@60Hz
	1600x1200@60Hz	1920x1080@60Hz
	1600x900@60Hz	1680x1050@60Hz
	1440x1050@60Hz	1600x1200@60Hz
	1440x900@60Hz	1600x900@60Hz
	1280x1024@60Hz	1440x1050@60Hz
	1280x800@60Hz	1440x900@60Hz
	1280x720@60Hz	1280x1024@60Hz

	1152x864@60Hz	1280x800@60Hz
	1024x768@60Hz	1280x720@60Hz
	800x600@60Hz	1152x864@60Hz
	720x480@60Hz	1024x768@60Hz
	640x480@60Hz	800x600@60Hz
	/	720x480@60Hz
	/	640x480@60Hz
Mac OS	1920x1080@60Hz	3840x2160@30Hz
	1920x1080@30Hz	2560x1440@60Hz
	1600x900@60Hz	1920x1080@60Hz
	1280x720@60Hz	1920x1080@30Hz
	/	1600x900@60Hz
	/	1280x720@60Hz

9. Specifications

Input Ports	USB-C Male or USB 3.0 Male x 1
Output Ports	HDMI x 2
Data Transmission Rate (Max)	5Gbps
Data Transmission Standard	USB 3.0 (USB 3.1 GEN 1)
Compatible OS	Windows 7/8.1/10/11 and above Mac OS 10.10.x and above Android 7.1 and above (Android devices only support mirroring mode with resolutions up to 1080P)

Operating Temperature	0°C to 60°C
Storage Humidity	5% to 90% RH non-condensation
Power Supply	USB3.0 USB-C from PC or notebook
Power Consumption (Max)	5W
Unit Cert	FCC, CE, RoHS
Dimension (LxWxH)	3.94x 1.97x0.53in (100x50x13.5mm)
Net Weight	78g
Material	ABS
User Manual	English Version

10. Connection Diagram



11. Troubleshooting Common Issues

Q: My USB 3.0 to HDMI Dual Display Adapter is not working. What should I do?

A: First, please check the following items:

1. Ensure that your device's USB port has a current output of 900mA or more. If not, try a different port.
2. Check if the correct drivers have been installed on your device.
3. Make sure that your HDMI cable and adapter are securely connected to your device.
4. Verify that your video source is compatible with the adapter.
5. Restart your device and see if this resolves the issue.

Q: My second display flickers when I use the adapter. What could be causing this?

A: This may be caused by one or more of the following:

1. Make sure the HDMI cable and adapter are securely connected.
2. Try using a different HDMI cable to see if this resolves the issue.
3. Check that your device is providing sufficient power to the adapter (900mA or more).
4. Verify that your video source is compatible with the adapter.
5. Try using a different USB 3.0 port or restarting your device.

Q: The adapter is not displaying video on my second monitor. How can I fix this?

A: Please check the following items:

1. Ensure that your HDMI cable and adapter are securely connected.
2. Verify that your video source is compatible with the adapter.
3. Check the driver version for the adapter, and make sure it is up-to-date.
4. Make sure your device is providing sufficient power to the adapter (900mA or more).

5. Try using a different USB 3.0 port or restart your device.

12. Maintenance

Clean this unit with a soft, dry cloth. Never use alcohol, paint thinner, or benzine to clean.

13. Warranty

If your product does not work properly because of a defect in materials or workmanship, our company (referred to as “the warrantor”) will, for the length of the period indicated as below, “Parts and Labor (1) Year”, which starts with the date of original purchase (“Limited Warranty period”), at its option either (a) repair your product with new or refurbished parts, or (b) replace it with a new or a refurbished product. The decision to repair or replace will be made by the warrantor.

During the “Labor” limited warranty period, there will be no charge for labor. During the “Parts” warranty period, there will be no charge for parts. You must mail-in your product during the warranty period. This Limited Warranty is extended only to the original purchaser and only covers products purchased as new. A purchase receipt or other proof of original purchase date is required for Limited Warranty service.

14. Mail-In Service

When shipping the unit, carefully pack and send it prepaid, adequately insured, and preferably in the original carton. Include a letter detailing the complaint and provide a day time phone and/or email address where you can be reached.

15. Limited Warranty Limits and Exclusions

This Limited Warranty ONLY COVERS failures due to defects in material or workmanship, and DOES NOT COVER normal wear and tear or cosmetic damage. The Limited Warranty ALSO DOES NOT COVER damages which occurred in shipment, or failures which are caused by products not supplied by warrantor, or failures which result from accidents, misuse, abuse, neglect, mishandling, misapplication, alteration, faulty installation, set-up adjustments, mis-adjustment of consumer controls, improper maintenance, power line surge, lightning damage,

modification, or service by anyone other than a Factory Service center or other Authorized Servicer, or damage that is attributed to acts of God.

THERE ARE NO EXPRESS WARRANTIES EXCEPT AS LISTED UNDER "LIMITED WARRANTY COVERAGE". THE WARRANTOR IS NOT LIABLE FOR INCIDENTAL OR CONSEQUENTIAL DAMAGES RESULTING FROM THE USE OF THIS PRODUCT, OR ARISING OUT OF ANY BREACH OF THIS WARRANTY. (As examples, this excludes damages for lost time, cost of having someone remove or re-install an installed unit if applicable, travel to and from the service, loss of or damage to media or images, data or other recorded content. The items listed are not exclusive, but are for illustration only.) PARTS AND SERVICE, WHICH ARE NOT COVERED BY THIS LIMITED WARRANTY, ARE YOUR RESPONSIBILITY.



WWW.JTECHDIGITAL.COM
PUBLISHED BY J-TECH DIGITAL INC.

9807 EMILY LANE
STAFFORD, TX 77477
TEL: 1-888-610-2818
E-MAIL: SUPPORT@JTECHDIGITAL.COM