



Website: www.jtechdigital.com

Toll Free: 1-888-610-2818

Email: support@jtechdigital.com

USER MANUAL

HDMI 18G Extender 230Ft DownScale
Model: JTECH-EX230



JTD-ID: 536



The **18G Extender Set** Control Path has been tested for conformity to safety regulations and requirements, and has been certified for international use. However, like all electronic equipment, the **JTECH-EX230** should be used with care. Please read and follow the safety instructions to protect yourself from possible injury and to minimize the risk of damage to the unit.

- Follow all instructions and warnings marked on this unit.
- Do not attempt to service this unit yourself, except where explained in this manual.
- Provide proper ventilation, air circulation, and do not use near water.
- Keep objects that might damage the device away and assure that the placement of this unit is on a stable surface.
- Use only the power adapter, power cords, and connection cables designed for this unit.
- Do not use liquid or aerosol cleaners to clean this unit. Always unplug the power to the device before cleaning.

TABLE OF CONTENTS

INTRODUCTION	1
PACKAGE LIST	1
FEATURES	1
PANEL DESCRIPTION	2
PANEL DESCRIPTION	3
SYSTEM CONNECTION	3
SPECIFICATION	4

INTRODUCTION

The JTECH-EX230 is a cost-effective point-to-point extender set for HDMI 2.0 and IR signals; this kit supports 4K/UHD video @ 60 Hz with 4:4:4 Chroma sampling, as well as HDMI data rates up to 18 Gbps, HDCP 2.2 compliant; It provides HDMI transmission up to 230 feet (70 meters) for 4K@60Hz 4:4:4 or 1080p, over single CAT5e/6 cable. It supports video resolution down-scaling, the 4K input can be automatically downscale to 1080p output for compatibility with 1080p display.

PACKAGE LIST

- 1x Transmitter (Tx)
- 1x IR Receiver
- 1x Power Adapter (5V DC 1A)
- 1x User Manual
- 1x Receiver (Rx)
- 1x IR Emitter
- 2x Velcro Tape

FEATURES

- Supports HDMI 2.0, up to 4K@60Hz 4:4:4, HDR, 18G, HDCP 2.2.
- Extends 4K or 1080p HDMI signal up to 230 feet (70m) over a single CAT5e/6 cable.
- HDMI loop out on transmitter.
- Bi-directional IR pass-through.
- Supports video resolution down-scaling, the 4K input can be automatically degraded to 1080p output on receiver for compatibility with legacy 1080p display device.
- Features visually lossless compression with no latency.
- EDID pass-through.
- Compact design, easy to install and simple to operate.

Transmitter Panel Description

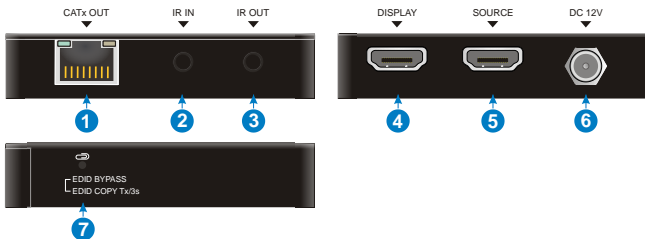

- ① **CATx OUT:** RJ45 port to connect the CATx IN port of receiver by CATx cable. It supports 12V PoC to power the receiver. The orange LED illuminates when there is a valid HDMI signal input. The green LED illuminates when power is applied.
- ② **IR IN:** 3.5mm mini jack to connect IR receiver for IR pass-through.
- ③ **IR OUT:** 3.5mm mini jack to connect IR emitter for IR pass-through.
- ④ **DISPLAY:** Type-A female HDMI port to connect HDMI display device.
- ⑤ **SOURCE:** Type-A female HDMI port to connect HDMI source device.
- ⑥ **DC 12V:** DC connector for the power adapter connection.
- ⑦ **EDID Management:** Press the button with paper clip or other sharp tool to set EDID bypass mode, or press and hold it for 3 seconds to copy the EDID from the display device.

Note: Press and hold the button while powering off, and then release it after 5 seconds of power on to restore the default setting: The source device learns EDID from the TV which has the lowest resolution.

PANEL DESCRIPTION

Receiver Panel Description

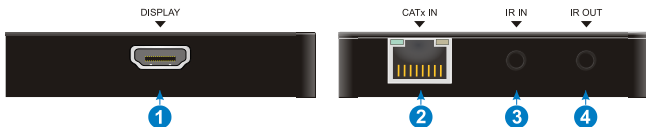

- ① **DISPLAY:** Type-A female HDMI port to connect HDMI display device.
- ② **CATx IN:** RJ45 port to connect the CATx OUT port of transmitter by CATx cable. It supports 12V PoC and the receiver can be powered from the transmitter. The orange LED illuminates when there is a valid HDMI signal input. The green LED illuminates when power is applied.
- ③ **IR IN:** 3.5mm mini jack to connect IR receiver for IR pass-through.
- ④ **IR OUT:** 3.5mm mini jack to connect IR emitter for IR pass-through.

SYSTEM CONNECTION

The following diagram illustrates the typical input and output connection of the splitter:

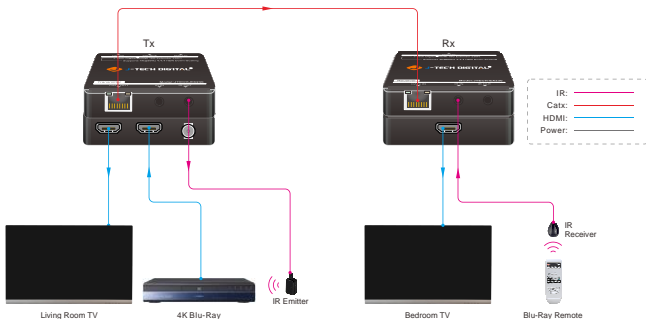

SPECIFICATION

Transmitter	
Input	(1) SOURCE
Input Connector	(1) 19-pin type-A female HDMI
Output	(1) DISPLAY, (1) CATx OUT
Output Connector	(1) 19-pin type-A female HDMI, (1) RJ45
Control	(1) IR IN, (1) IR OUT
Control Connector	(2) 3.5mm mini jacks
Receiver	
Input	(1) CATx IN
Input Connector	(1) RJ45
Output	(1) DISPLAY
Output Connector	(1) 19-pin type-A female HDMI
Control	(1) IR IN, (1) IR OUT
Control Connector	(2) 3.5mm mini jacks
General	
Video Resolution	Up to 4K@60Hz 4:4:4, HDR
Transmission Distance	4K/1080p ≤ 70 meters (230ft)
HDMI Version	Up to HDMI 2.0
HDCP Version	Up to HDCP 2.2. The HDCP of output follows the HDCP version of display device.
EDID Pass-through	Supported.
Power Supply	Input: 100VAC~240VAC, 50/60Hz; Output: 12VDC 1A
Power Consumption	4W (Max)
Operation Temperature	-5~55°C
Storage Temperature	-25~70°C
Relative Humidity	10%-90%
Dimensions (W*H*D)	80mm x 16.8mm x 80mm
Net Weight	Tx/Rx: 70g

Note: The extender set does not support HBR audio.



Scan this QR code using your smartphone to view the full J-Tech Digital Product Lineup!



Have more questions? Scan this QR code using your smartphone to contact us!



www.jtechdigital.com

J-Tech Digital®
12803 Park One Drive
Sugarland, TX 77478

- Product pictures are for reference only.
- Specifications, pictures & software described herein are subject to change without prior notification.
- Only use the provided power supply when operating this unit. J-Tech Digital® is not responsible for any damage due to customer neglect.
- All trademarks are the sole property of their respective companies.
- Copyright ©J-Tech Digital, Inc. All rights reserved.